

Specifications

- Current : 700mA (Constant Current)
- Wattage : 2.1W
- LED Color : 3000K (30K)
5000K (50K)
- Beam angle : Special (Asymmetrical Lens)
- CRI : 80
- Body color : Black (B)
- IP rating : IP66

* The constant current power supply is required.

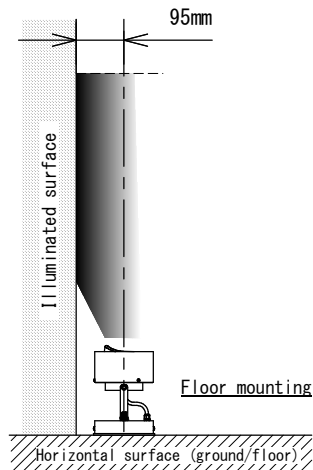
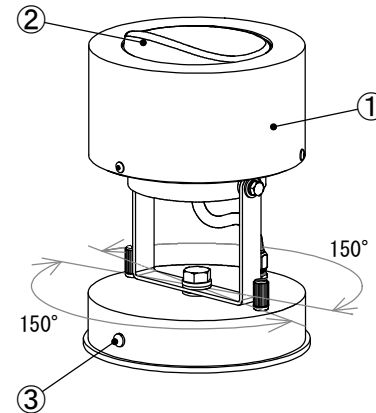
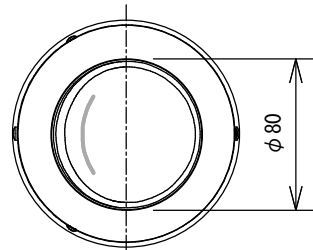

* The optimum distance to the illuminated surface is 95mm away from the center of a fixture.
For adjusting the height of the light beam, tilt the fixture head moderately.

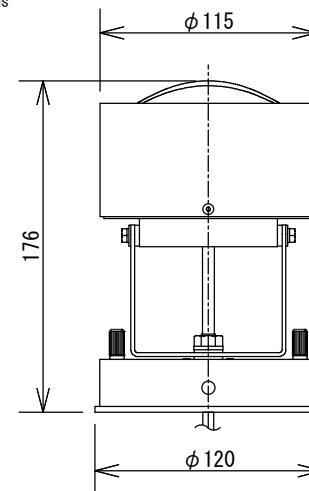
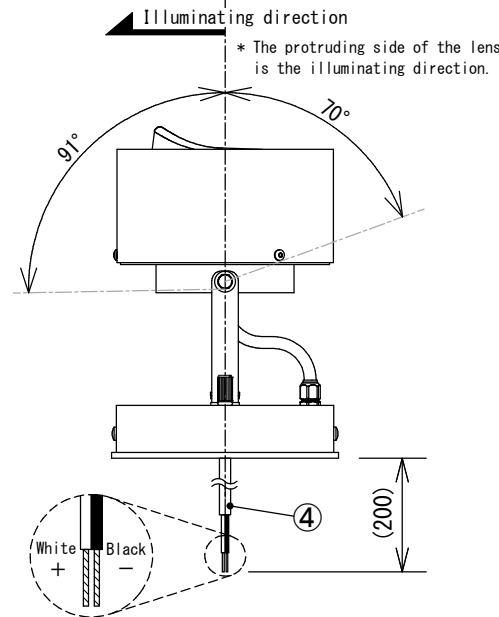

■ Installation

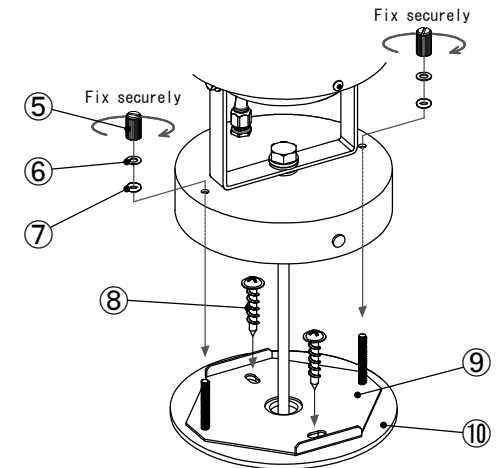

■ Mounting Dimension

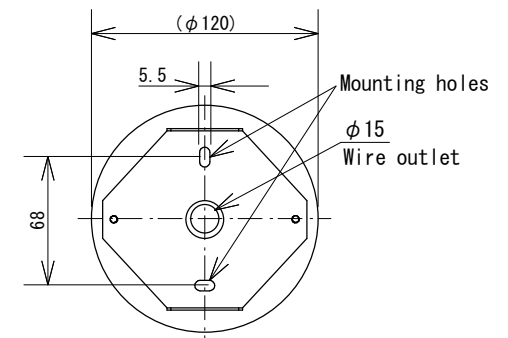

10	Gasket	Rubber	Black, 2mm thick
9	Mounting base	SUS	
8	Mounting screws	SUS	
7	O-ring	NBR	Black
6	Washer	SUS	Black
5	Nut	Brass	Black, Knurled nut
4	Lead wire	PVC	AWG18x2C
3	Bushing for drain hole	TPE	
2	Lens	Hard glass	
1	Fixture housing	AL, SUS, PC	
No.	Parts 部品	Material 材料	Memo 備考

Date 日付 2017/4/19

Draft 製図 D. Miwa

Check 検図 T. Shimamura

Approve 承認 C. Ishibiki

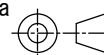

Scale 縮尺 1 : 4

Weight 重量 770g

Unit 单位 mm

Size 用紙 A4

Title 名称	Focal Line (Horizontal mounting)
--------------------	----------------------------------

Product No. FS01- K-L-B
製品番号 LED Color



TOKI CORPORATION
トキ・コーポレーション株式会社