

# TOKISTAR

PRODUCT GUIDE

## FOCAL SERIES

FOCAL SPOTMINI

FOCAL SPOTLIGHT

FOCAL LINE



2F JS Progre, 4-1-23, Heiwajima, Ota-ku, Tokyo 143-0006, Japan

TEL : +81-3-5763-6121 FAX : +81-3-5763-6130

[www.toki.co.jp/tokistar/en/](http://www.toki.co.jp/tokistar/en/)

### PRECAUTIONS

1. Read all instructions completely before beginning installation.
2. Turn off electricity before beginning installation.
3. All wiring is to be performed by a qualified electrician.
4. Installation must comply with the National Electrical Code, or all applicable codes.
5. Turn main supply to LED Driver on only after all connections have been made and tested.
6. Use only LED Drivers provided by Tokistar with the system.





**#01** A certain hospital in Kagoshima,  
Elevator hall

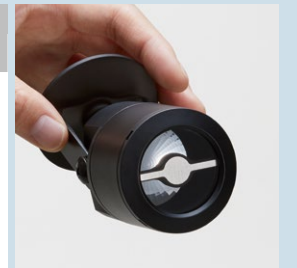
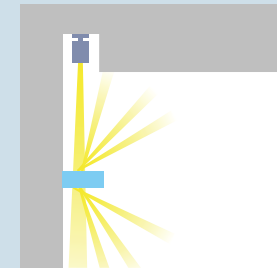

## FOCAL SPOTMINI

FSMDR01-50K-03D-W (Custom)

Art Produce : ARTCOCO

Design : Hajime Shimoyama

Photograph : © KENKATO

▶▶ Page 3-4

**#02** TOKYO NATIONAL MUSEUM  
Heiseikan : Japanese Archaeology Gallery

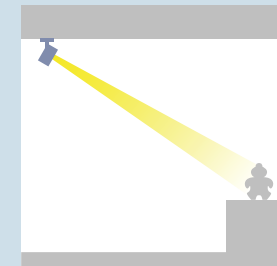

## FOCAL SPOTLIGHT

FSDR01-HC50K-03D-B

▶▶ Page 5-6

**#03** MITSUBISHI ESTATE HOME  
Komazawa Stage 1 Home Gallery

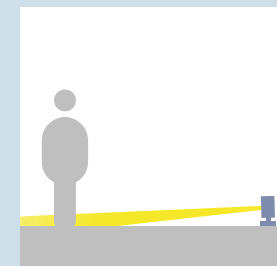

## FOCAL LINE

FS01-5000K-L-B

Design : MITSUBISHI ESTATE HOME CO.,Ltd

▶▶ Page 7-8

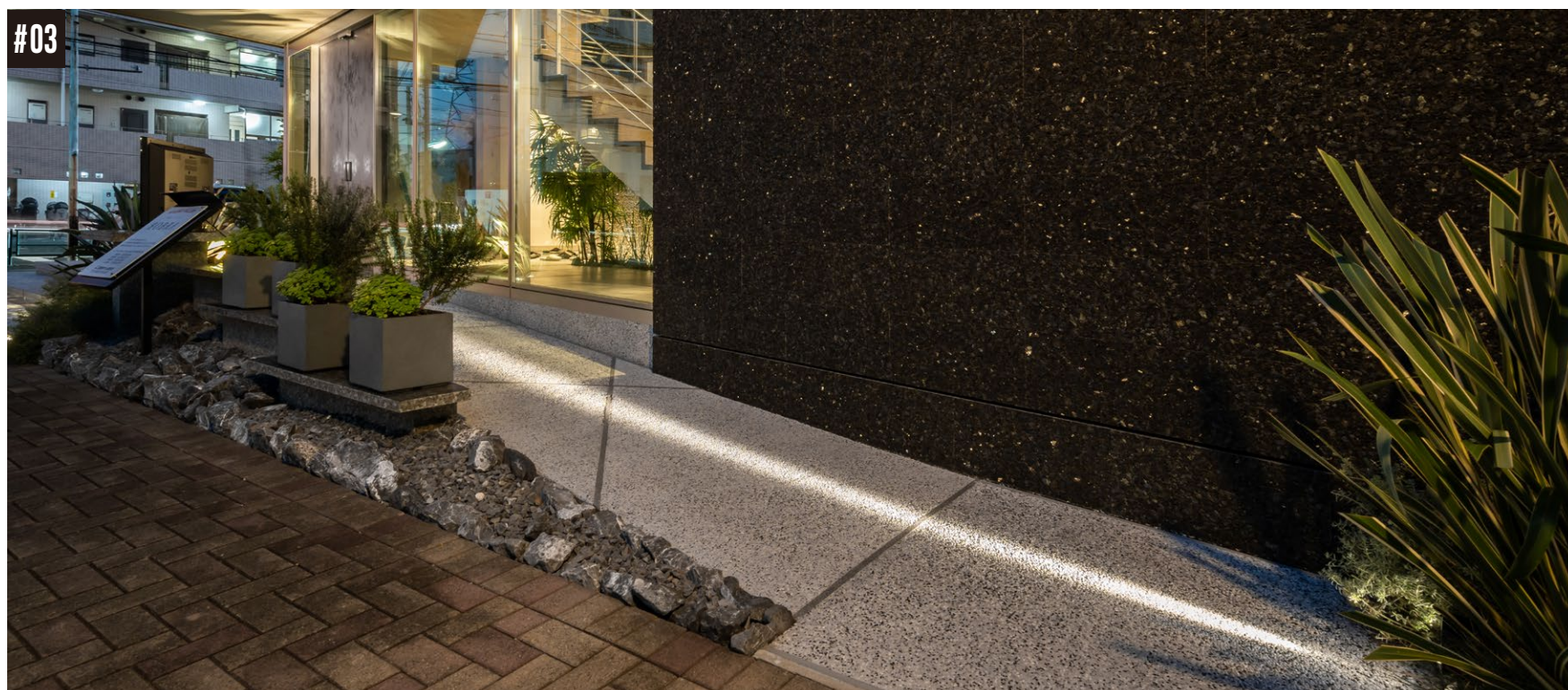



# FOCAL SPOTMINI



INDOOR

700mA

DALI

CRI85

CRI95

Current = 700mA

Wattage = 2.1W

Weight = 240g

Main Materials = Aluminum, PBT/PC & PMMA

FSM01-K-03D-

LED Color		Beam Angle	Fixture Color
CRI85	CRI95	03D : 3°	B : Black
27K : 2700K	HC27K		W : White
30K : 3000K	HC30K		
50K : 5000K			

System Features

Point  
01

Precise Control

The special reflector developed for Focal Spotlight has been miniaturized, yet still maintains an ultra-narrow beam angle and light homogeneity. The significantly reduced size and weight make it ideal for interior use.



Rotation : 360°

Pivot : 90°  
Fixture head rotates and pivots.

Narrow Beam Angle : 3°  
Glare-free light precisely where you aim.

Point  
02

Glare-free ultra-narrow beam angle

The optical design suppresses light leakage. Because of the ultra-narrow angle of light distribution, glare is almost non-existent. This satisfies the demand of "I only want to illuminate this part" of paintings and exhibits in art galleries or museums.



TOKYO NATIONAL MUSEUM

Heiseikan : Japanese Archaeology Gallery

National Treasure : Haniwa Warrior in keiko armor

FSM01-3000K-03D-W

Specifications

Cutout :  $\Phi 50 \begin{smallmatrix} +2mm \\ -0mm \end{smallmatrix}$   
Panel thickness : 5 ~ 25mm  
Embedded height : 70mm



Product Component

Focal Spotmini requires power supplies.



Focal SpotMini

LDCC-15W-700DALI LED Driver

No longer than AWG18x2C 40m

Installation

Please contact us if you want different specifications such as wall mounting.



Minimum space requirements



Light Distribution

Values shown are for 3000K modules

03D

5	$\Phi 0.25$	432
10	$\Phi 0.5$	108
15	$\Phi 0.75$	48
20	$\Phi 1.0$	27

Distance [m]      Illuminance [lx]

Recommended uses for this series

1. Focus on parts of exhibits or fine works

2. Spatial production for theaters, halls, etc

3. Accenting items in restaurants, banquets, etc.

Before

After



Refer to Page 9 for the power supply and dimming of Focal SpotMini.

3

4

# FOCAL SPOTLIGHT



Current = 700mA

Wattage = 2.1W

Weight = 710g

Main Materials = Aluminum, Stainless Steel & PC

FS01-

3000K

5000K

03D : 3°

B : Black

LED Color

Beam Angle

Fixture Color

System Features

Point 01

Ultra-narrow angle spotlight with 3° light distribution for precise aim



This outdoor spotlight has a ultra-narrow angle of light distribution, and 30,000 cd luminous intensity. It is ideal for pinpointing distant objects. The uniquely designed reflector delivers glare-free, uniform light distribution with a soft edge.

Point 02

Innovative optical design



A specially designed reflector produces uniform, highly concentrated light distribution that effectively eliminates light leakage.

Specifications



Installation



For Wall Mounting

When affixing the fixture to a wall, make sure one of the canopy drain holes is facing downward. Remove the bushing facing downward.



Product Component

Focal Spotlight requires power supplies.



LDC-15W-700DALI LED Driver

Focal Spotlight

No longer than AWG18x2C 40m

Light Distribution

Values shown are for 5000K modules

O3D (30300cd)

Distance[m]	Beam Diameter	Illuminance[lx]
5	Φ0.25	1213
10	Φ0.5	303
15	Φ0.75	135
20	Φ1.0	76



Recommended uses for this series

- Applications requiring a narrow beam of light.
- Linear accents on building exteriors
- Highlighting distant objects such as sign boards and nameplates on commercial facilities



Refer to Page 9 for the power supply and dimming of Focal Spotlight.

5

6

## FOCAL LINE



Current = 700mA  
Wattage = 2.1W  
Weight = 770g  
Main Materials = Aluminum, Stainless Steel & PC

**FS01- □□□□K-L-B**

**LED Color**

3000K  
5000K

**Fixture Color**

B : Black

## System Features

**Point  
01**

Equipped with a uniquely designed polarized light distribution lens



Original design  
Special lens  
(patented)

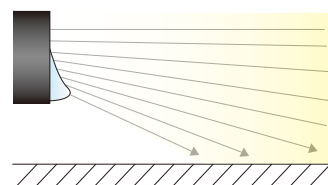

Because of the unique polarized lens, it is possible to maintain a narrow light distribution and illuminate only the walls and pillars you want to illuminate.

**Point  
02**

For new performance expressions

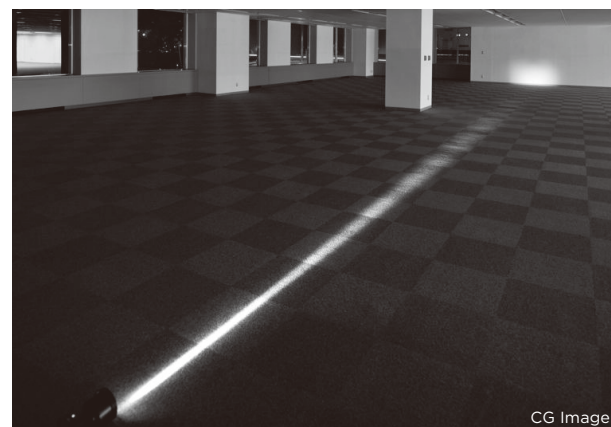

CG Image

You can create an effect that has been difficult to achieve in the past, long linear beams of light. In addition to architectural displays, fixtures can also be used for promotional events.

## Specifications

(mm)

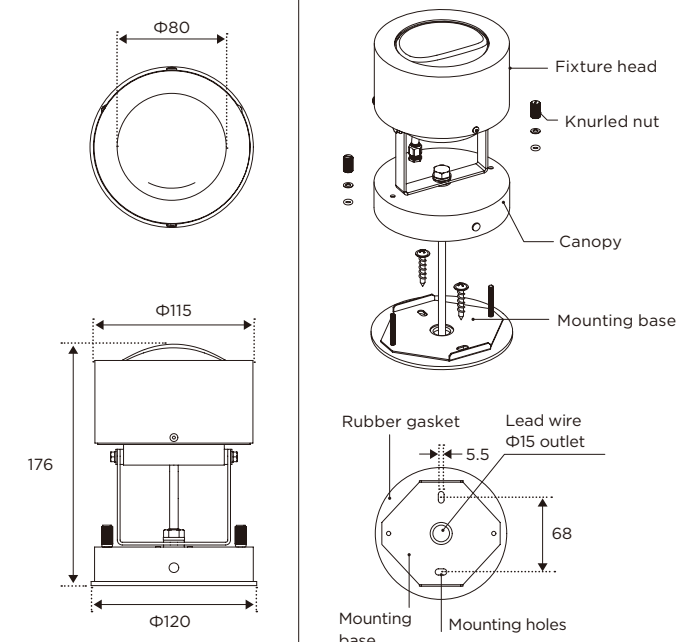

## Product Component

Focal Line requires power supplies.

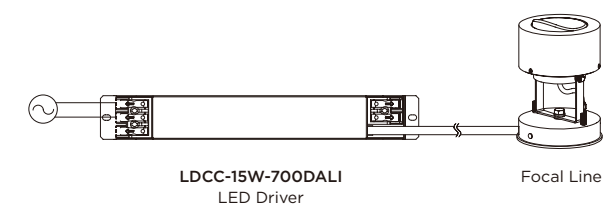

No longer than AWG18x2C 40m

## Recommended uses for this series

1. Architectural use Facades, Uplighting, Mullions, Eaves, etc. Produces narrow light effects.
2. Event use Lighting a pathway across ground or highlighting a wall, etc.

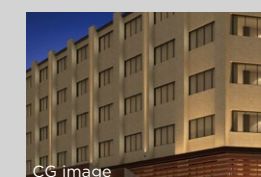

CG image

## Installation

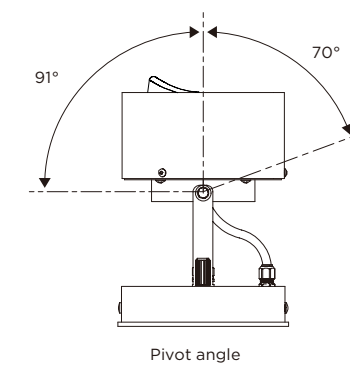

Pivot angle

## For Wall Mounting

When affixing the fixture to a wall, make sure one of the canopy drain holes is facing downward. Remove the bushing facing downward.

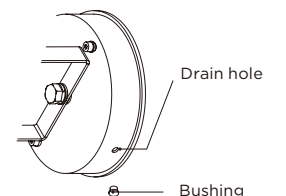

Mounting holes

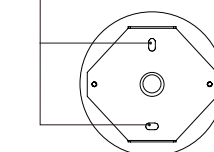

Set the mounting base in the orientation shown in the left figure.

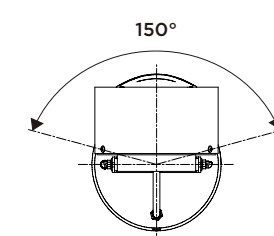

Rotation angle :  
When irradiation  
direction is upward

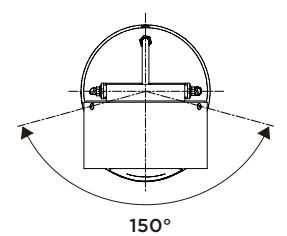

Rotation angle :  
When irradiation  
direction is downward

## Light Distribution

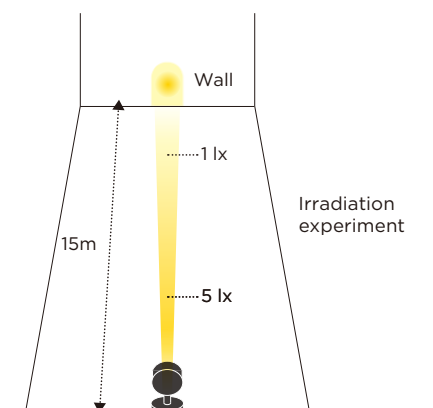

Refer to Page 9 for the power supply and dimming of Focal Line.

Power Supply

LDCC-15W-700DALI  
(mm)

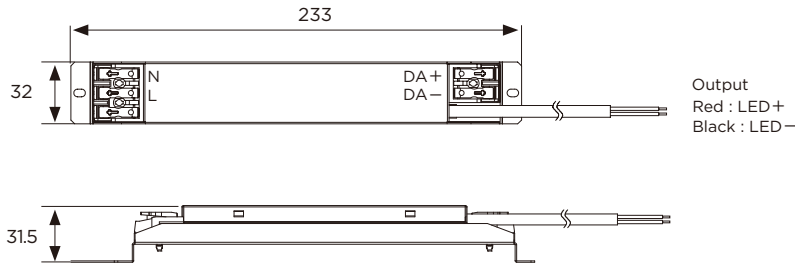

- Specifications**  
Input Range : 100-240VAC  
Frequency Range : 50/60 Hz  
Output : 2.5-15VDC  
Current : 700mA  
Max. Output Power : 15W(MAX)  
Protection : Overload, Overcurrent, Short Circuit  
Operating Temperature : 0°C to +40°C
- Mechanical Specifications**  
Dimensions : W 32 x L 233 x H 31.5 mm  
Weight : 220g
- LED Capacity**  
1-3 Fixtures



Wiring Diagram

Multiple Fixture Diagram

From 1-3 fixtures can be fed from a single LED driver. These may be wired in a series/loop configuration.

